

List of Maps, Images, and Graphic Materials (paginated within document)

FIG.	TITLE	SOURCE
1	Site map (red circle indicates location of site)	Google maps, www.google.com, 2009.
2	Aerial view of neighborhood (red circle indicates location of site)	Google maps, www.google.com, 2009.
3-4	Zoning map, Seattle Department of Planning and Development, 2010	Seattle Department of Planning and Development, 2010
5	Graphical summary of PSC building alterations	NK Arch., 2010
6	Aerial view of complex from south	Google maps, 2009
7	Aerial view of complex from east	Google maps, 2009
8	1939 view of Seattle's civic center, location of 1962 Seattle World's Fair. Future United States Science Pavilion location visible in upper portion, just right of center	1983.10.17888, PEMCO Webster & Stevens Collection, MOHAI
9	1962 Seattle World's Fair, c. 1962	1965.3598.4.6, MOHAI
10	1962 Seattle World's Fair. View of South entry gate, c. 1962	1965.3598.5.7, MOHAI
11	1962 Seattle World's Fair; view from axial approach. The Standard Oil Pavilion is visible at left, c. 1962.	www.Flickr.com photosharing site; member LREED 7649 1465045497_641b6d21ae_b.jpg
12	Science Pavilion under construction, c.1961	1965.3598.26.57, MOHAI
13	1962 Seattle World's Fair advertisement showing construction of the Science Pavilion	June 1962 Progressive Architecture magazine
14-15	1962 Seattle World's Fair	Period postcard, c. 1962
16	1962 Seattle World's Fair guidebook showing cut-away diagram of interior exhibits at the United States Science Pavilion	Official Guide Book Seattle World's Fair 1962. Seattle, WA: Acme Publications Incorporated, 1962?
17	1969 exhibit at the Pacific Science Center, c. 1969	1986.5.50939, Seattle P-I Collection, MOHAI
18	Wayne State University McGregor Conference Center, Detroit, Michigan, by Minoru Yamasaki 1955-59	Date and source unknown
19	Oberlin College Conservatory of Music buildings, Oberlin Ohio, 1963 by Minoru Yamasaki	Date and source unknown
20	Reynolds Aluminum Building, Detroit, Michigan, by Minoru Yamasaki, 1959	Date and source unknown
21	IBM Building, Seattle, 1964 (left) and Rainier Tower, Seattle, 1977 (right) both by Minoru Yamasaki	Date and source unknown
22	Neighborhood context: view east from John Street	NK Arch., Nov. 2009
23	Neighborhood context: view south from Seattle Center; 1982 Bay Vista Tower apartment building in background, Children's Theater on far right	NK Arch., Nov. 2009
24	Neighborhood context: view west from John Street and 5th Avenue monorail tracks	NK Arch., Nov. 2009
25	Neighborhood context: view west/northwest on 3rd Avenue from Belltown	NK Arch., Nov. 2009
26	Neighborhood context: view along Broad Avenue of IMAX wing addition	NK Arch., Nov. 2009
27	Neighborhood context: view of Pacific Science Center and Space Needle from upper main path at the Olympic Sculpture Garden on	NK Arch., Nov. 2009

	the Elliott Bay waterfront	
28	North entrance forecourt and entry towers, from northeast	NK Arch., Mar. 2009
29	Entrance stairs and 1993 north entrance gate	NK Arch., Mar. 2009
30	Building 5 (1962: Building 1) east elevation, and walkways	NK Arch., Mar. 2009
31	Building 4 (1962: Building 2) east elevation, on left	NK Arch., Mar. 2009
32	Laser Dome (1962: Building 3), north elevation	NK Arch., Mar. 2009
33	Building 3 (1962: Building R), north elevation, on right; Building 2 (1964: Building 4) on left. 1962 viewing platform at center. Non-original features shown include 1993 pool pad and walk visible at right, tent, signage, glazed wall on Building 3, and all water features other than petalled fountain.	NK Arch., Mar. 2009
34	Building 1 (1962: Building 5), center; Building 2 (1965: Building 4) on right	NK Arch., Mar. 2009
35	Building 5 (1962: Building 1) first level conference room	NK Arch., Mar. 2009
36	Building 5 (1962: Building 1) west elevation, and loading dock	NK Arch., Mar. 2009
37	Southeast corner of site showing 1993 parking garage addition	NK Arch., Mar. 2009
38	Pacific Science Center south perimeter elevation showing additions to Building 3 (1962: Bldg R) on right	NK Arch., Mar. 2009
39	Pacific Science Center south perimeter elevation showing Building 2 (1962: Building 4) on left, and 1998 butterfly house and IMAX addition on right	NK Arch., Mar. 2009
40	Pacific Science Center, east perimeter elevation, showing 1998 butterfly house and IMAX addition behind trees; view from Seattle Center grounds	NK Arch., Mar. 2009
41	Pacific Science Center, north elevation showing Building 1 (1962: Building 1) on right, and 1998 Boeing IMAX addition on left; view from Seattle Center grounds	NK Arch., Mar. 2009
42	Building 1 (1962: Building 5) on right, 1998 Boeing IMAX addition on left; site of 1962 East Exhibit Garden	NK Arch., Nov. 2009
43	Building 5 (1962: Building 1) on left, 1996 Discovery Labs addition on right (east elevation)	NK Arch., Nov. 2009
44	Building 5 (1962: Building 1) on right, 1996 Discovery Labs addition on left (west elevation)	NK Arch., Nov. 2009
45	Building 5 (1962: Building 1) first level corridor	NK Arch., Nov. 2009
46	Building 5 (1962: Building 1) first level typical office; view through window of hallway of 1993 Discover Labs building addition	NK Arch., Mar. 2009
47	View of Building 5 (1962: Building 1) first floor original exterior wall, from lobby and hallway of 1993 Discovery Labs addition. In 1962 these office windows overlooked the West Exhibit Garden.	NK Arch., Nov. 2009
48	Building 5 (1962: Building 1) second level theater and structure behind curving wall	NK Arch., Nov. 2009
49	Building 5 (1962: Building 1) second level theater	NK Arch., Mar. 2009
50	Building 4 (1962: Building 2), interior, showing west ramp from mezzanine	NK Arch., Nov. 2009
51	Building 4 (1962: Building 2), interior, showing exhibits and structure area	NK Arch., Nov. 2009
52	Laser Dome (1962: Building 3) theater interior	NK Arch., Nov. 2009
53	Laser Dome (1962: Building 3) theater; view of dome structure from interstitial space storage	NK Arch., Mar. 2009
54	Building 3 (1962: Building R), interior, showing 1993 full height glazed wall	NK Arch., Nov. 2009
55	Building 3 (1962: Building R), interior, showing Denny Way entrance below	NK Arch., Mar. 2009

56	Building 2 (1962: Building 4), interior showing exhibits, and staff office area up stairs on left	NK Arch., Mar. 2009
57	Building 2 (1962: Building 4), interior	NK Arch., Mar. 2009
58	Building 1 (1962: Building 5), interior showing original mezzanine	NK Arch., Mar. 2009
59	Typical basement view under original 1962 buildings	NK Arch., Mar. 2009
60	1998 Boeing IMAX Theater and Exhibit Wing addition; interior looking north; theater on right	NK Arch., Nov. 2009
61	1998 Boeing IMAX Theater and Exhibit Wing addition; interior looking southeast to Seattle Center grounds through windows on left	NK Arch., Nov. 2009
62-63	1993 north entry ticket kiosks	NK Arch., Mar. 2009
64	1962 entry towers, pools, fountains	NK Arch., Mar. 2009
65	1962 entry towers, custom pendant light, custom hardware	NK Arch., Mar. 2009
66	1962 custom petalled fountain	NK Arch., Mar. 2009
67	1962 pebble aggregate at pool bottom	NK Arch., Mar. 2009
68	1962 wall separating pools	NK Arch., Mar. 2009
69	1962 planters – tree rings	NK Arch., Mar. 2009
70	1962 custom planters	NK Arch., Mar. 2009
71	1962 custom benches	NK Arch., Mar. 2009
72	1962 custom paving pattern (1 of 3)	NK Arch., Mar. 2009
73	1962 recessed light fixtures in walks	NK Arch., Mar. 2009
74	1962 walkways and railings	NK Arch., Mar. 2009
75	1962 underside of tower platform	NK Arch., Mar. 2009
76	1962 stairs and railings	NK Arch., Mar. 2009
77	1962 porch at Building 5 (1962: Bldg 1)	NK Arch., Mar. 2009
78-79	Wall from 1962 West Exhibit Garden	NK Arch., Mar. 2009
80	West & East Exhibit Gardens at left. View of Fair grounds from Space Needle, c. 1962	www.Flickr.com photosharing site; member F LREED 7649 2940234532_fab336388f_o.jpg
81	1962 West or East Exhibit Gardens, c. 1962	United States Science Exhibit, Seattle World's Fair: Final Report. US Dept of Commerce, Wash., DC: 1962; p. 52
82	West elevation, Building 4 (1962: Building 2), showing garage entry and drive aisle	NK Arch., Nov. 2009
83	South elevation Building 4 (1962: Building 2) at left; west and south elevation Laser Dome (1962: Building 3) at middle and right; view from Pacific Science Center Parking Garage (not on site)	NK Arch., Nov. 2009
84	Pacific Science Center Parking Garage (not on site; property line follows building face of original building), showing engagement with original retaining wall of Southwest Terrace. Western portion of south elevation of Laser Dome visible upper left.	NK Arch., Nov. 2009
85	South elevation of Laser Dome (1962: Building 3) in background, with south retaining wall of Southwest Terrace in foreground.	NK Arch., Nov. 2009
86	Detail, south elevation Building 3 (1962: Building R).	NK Arch., Nov. 2009
87	South elevation of Building 4, Laser Dome, and Building 3 (left to right).	NK Arch., Nov. 2009
88	South elevation of Building 3 (1962: Building R), east part.	NK Arch., Nov. 2009
89	South elevation of Building 3 (1962: Building R), central part.	NK Arch., Nov. 2009
90	South elevation of Building 3 (1962: Building R), at left, and south	NK Arch., Nov. 2009

	elevation of Building 2 (1962: Building 4) at right.	
91	Southeast Terrace pebbled retaining walls in foreground; south and east elevations of Building 3 (1962: Building R) at upper left; south elevation of Building 2 (1962: Building 4) at upper right.	NK Arch., Nov. 2009
92	Raised viewing platform at south end of Central Courtyard.	NK Arch., Mar. 2009
93	Map showing future United States Science Pavilion site, c. 1951.	Sanborn Fire Insurance Map Company

Unpaginated Maps, Images, and Graphic Materials (following paginated portions of report)

TITLE	SOURCE
Site plan - Site sketch for Pacific Science Center, Seattle Historic Landmark Nomination (1 page)	NK Architects, February 26, 2010
Tax assessor records for United States Science Pavilion (8 pages)	King County Tax Assessor, 11/19/61
1-1 Site survey	Yamasaki & Assoc., 1960*
2-1 Site plan	Yamasaki & Assoc., 1960
3-1 Building # 1 ground floor plan	Yamasaki & Assoc., 1960
3-4 Building # 2 ground floor plan	Yamasaki & Assoc., 1960
3-4 11-104A Building # 2 ground floor plan – contract change - architectural	Yamasaki & Assoc., 1960
3-6 Building # 3 ground floor plan	Yamasaki & Assoc., 1960
4-1 North & east elevations	Yamasaki & Assoc., 1960
4-2 South & west elevations	Yamasaki & Assoc., 1960
4-5 Building sections	Yamasaki & Assoc., 1960
4-6 Building sections	Yamasaki & Assoc., 1960
5-10 Court paving details	Yamasaki & Assoc., 1960
5-12 Exhibit gardens, concrete fence plans	Yamasaki & Assoc., 1960
5-14 Concrete fences, walls & fountains	Yamasaki & Assoc., 1960
7-20 Entrance framing plan, upper level	Yamasaki & Assoc., 1960
7-25 Wall panel details	Yamasaki & Assoc., 1960
17-2 Exhibit gardens, landscape work [Lawrence Halprin, Landscape Arch]	Yamasaki & Assoc., 1960
34-3 Miscellaneous details	Yamasaki & Assoc., 1960
A2.1 Building No. 3 Demolition Plans (Building 3 & Site Improvements)	Callison Architects, 1993
A1.4 Gallery/Plaza – Floor Plan (New IMAX Theatre/Exhibit Hall)	Callison Architects, 1996
A2.1 Plaza Level – Floor Plan (Building 6A/Discovery Labs)	Callison Architects, 1996

* Drawings from Pacific Science Center collection, and on file at Seattle DPD Microfilm Library

APPENDIX A – BUILDING IMAGES

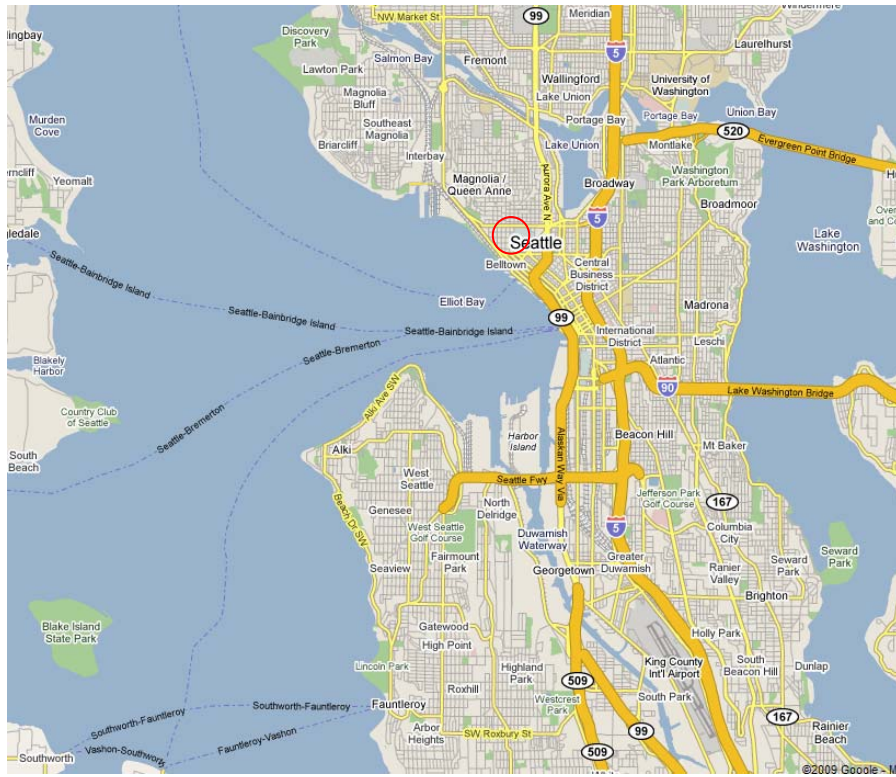

Figure 1 – Site map (red circle indicates location of site)

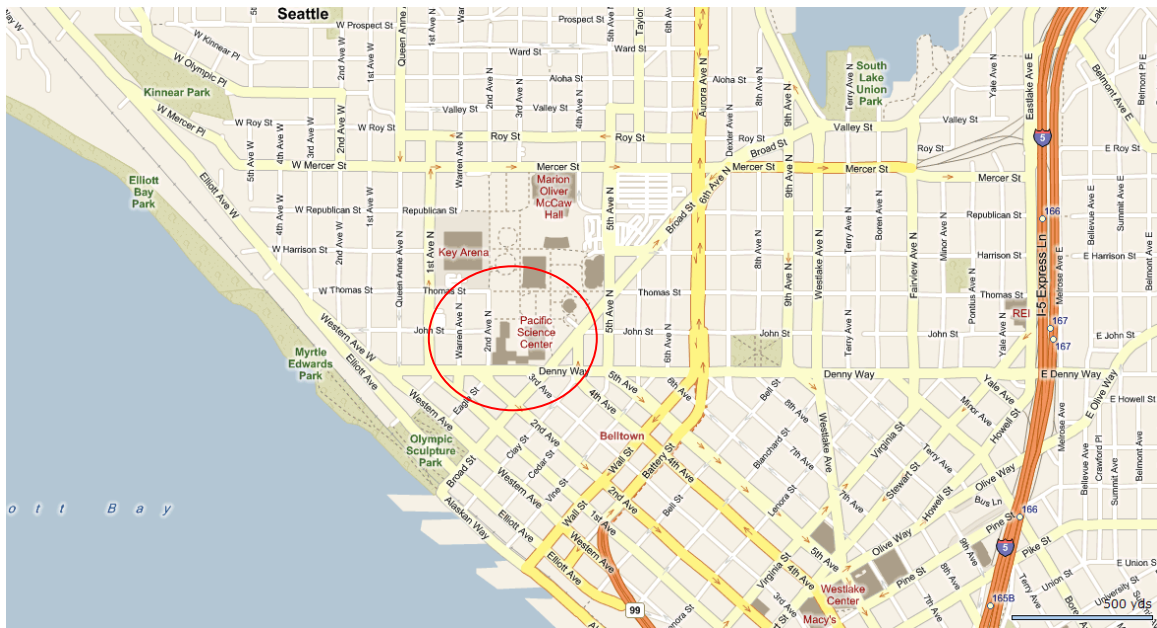
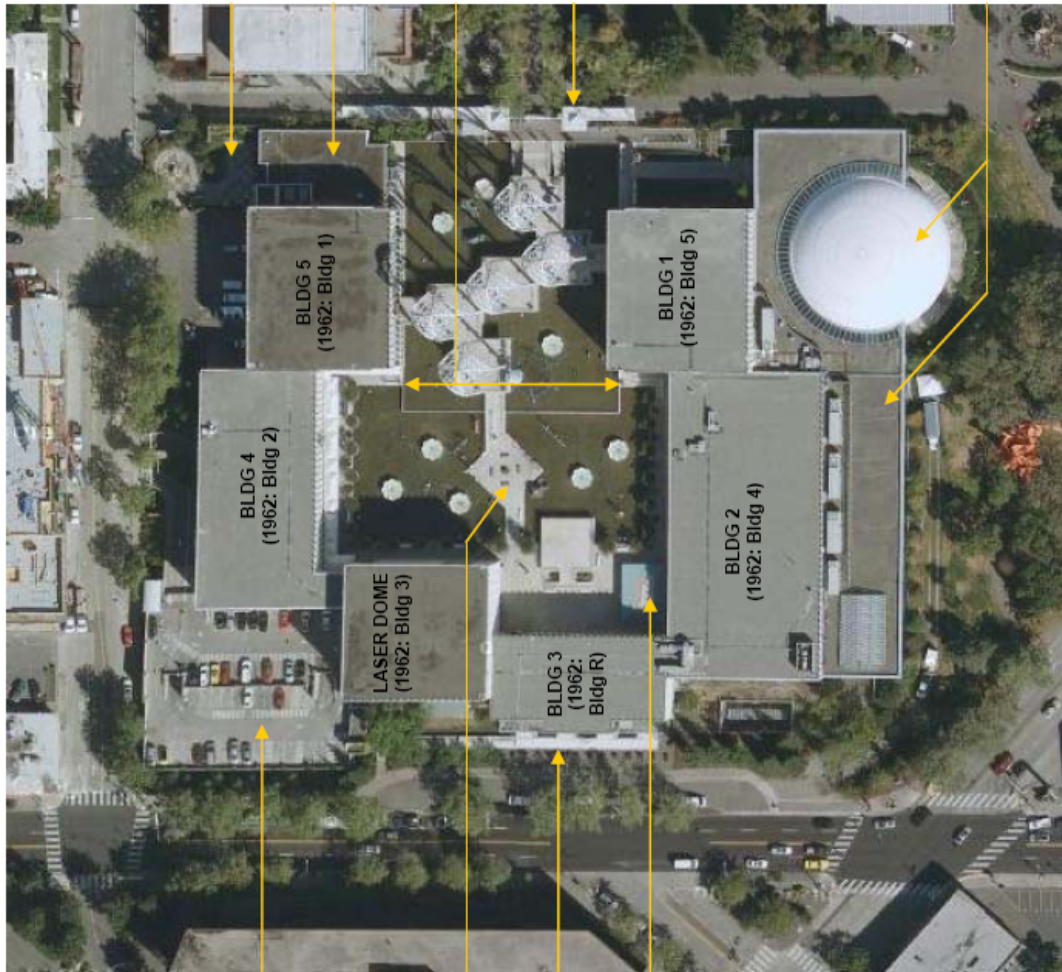

Figure 2 – Aerial view of neighborhood (red circle indicates location of site)

SITE, 2010

**NON-HISTORIC
ADDITIONS OR
RENOVATIONS**



Parking expansion and west garden regrading (1993)

Building 6A Discovery Labs (1996)

Installation of barrier free ramps (1993)

North Entrance Ticketing Kiosks and canopy (1993)

Building 1A and 2A Boeing IMAX Theater and Exhibit Wing (1998)



Building 8 Parking Garage (1998)
(Not part of original project property)

New pool pad and walkway (1993)

Building 3 Renovation, including glazing the north wall, and south entry (1993)

Lunch tent (temporary structure) (1993)

Aerial photo, c. 2009 (Google Maps online mapping) (no scale)

Figure 5 – Graphical summary of PSC building alterations, Nicholson Kovalchick Architects, 2010



Figure 6 - Aerial view of complex from south (Google maps, 2009)



Figure 7 - Aerial view of complex from east (Google Maps)



Figure 8 – 1939 view of Seattle's civic center, location of 1962 Seattle World's Fair. Future United States Science Pavilion location visible in upper portion, just right of center. (1983.10.17888, PEMCO Webster & Stevens Collection, MOHAI)



Figure 9 – 1962 Seattle World's Fair (1965.3598.4.6, MOHAI)



Figure 10 – 1962 Seattle World's Fair. View of South entry gate (1965.3598.5.7, MOHAI)



Figure 11 – 1962 Seattle World's Fair; view from axial approach. The Standard Oil Pavilion is visible at left.



Figure 12 – Science Pavilion under construction, c.1961 (1965.3598.26.57, MOHAI)

ABOVE: Sweeping the pavilion into place
LEFT: The prestressed components
BELOW: Mold of Science complex when finished

Architects: Mitsuru, Yamazaki & Associates, Detroit
Structural Engineers: Skidmore, Brown, Orin & Johnson, Seattle
Concrete Contractors: Northwest Concrete & Gravel, Inc.
Engineers: Worthington, Skilling, Harbo & Jackson, Seattle

...wherever concrete must be beautiful

The United States Science Pavilion is one of two principal theme buildings of the Seattle World's Fair. After the Fair it becomes the city's cultural center.

The load-bearing S-type stud wall panels are 32 and 52 feet long. They are faced with Trinity White portland cement and white quartzite aggregate. They are prestressed. The high strength

of Trinity White and the high-strength grey cement back-up permitted the forms to be stripped in 12 to 14 hours with steam curing. Panels are secured in place by either welding or bolting. Problems of repeated turning, handling and transporting these massive members were easily and ingeniously solved with specially outfitted lift trucks.

OFFICES: Chicago, Dallas, Denver, Detroit, Los Angeles, New York, Philadelphia, Portland, Seattle, San Francisco, St. Louis, Toronto, Washington, D.C., Wichita, Kansas

Trinity White
A product of GENERAL PORTLAND CEMENT COMPANY

For more information, turn to Reader Service card, page 46, 307

Figure 13 – 1962 Seattle World's Fair advertisement in June 1962 Progressive Architecture magazine, showing construction of the Science Pavilion



Figure 14 – 1962 Seattle World's Fair, period postcard

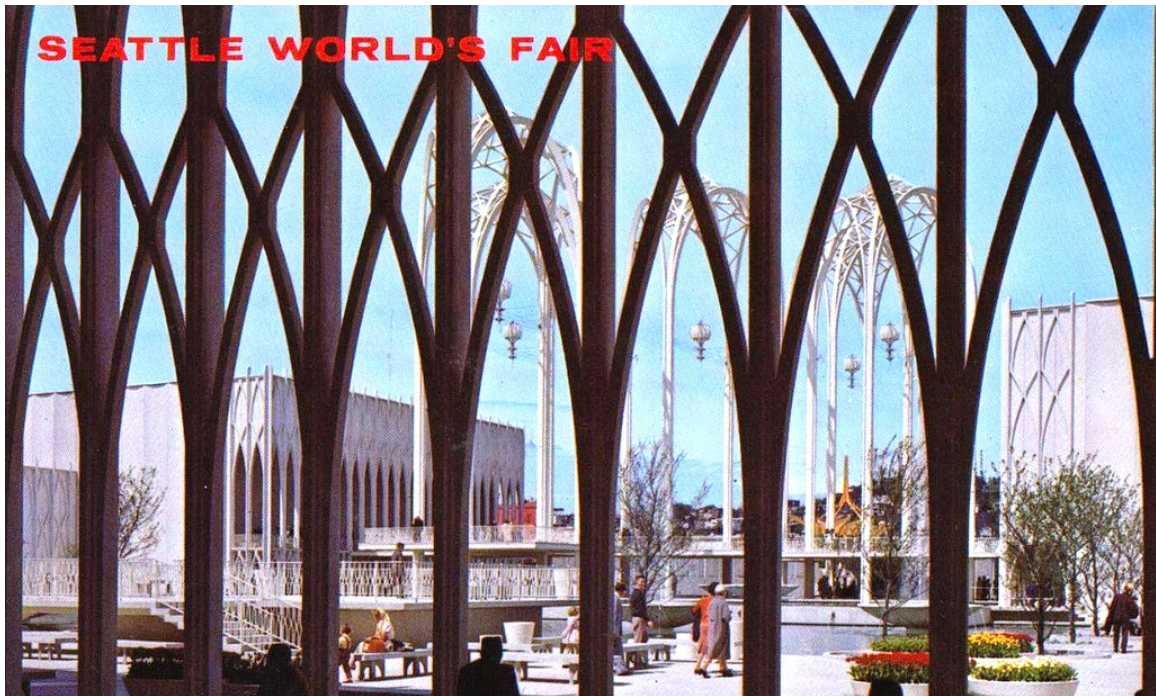

Figure 15 – 1962 Seattle World's Fair, period postcard; view from Building R (current Bldg 3)

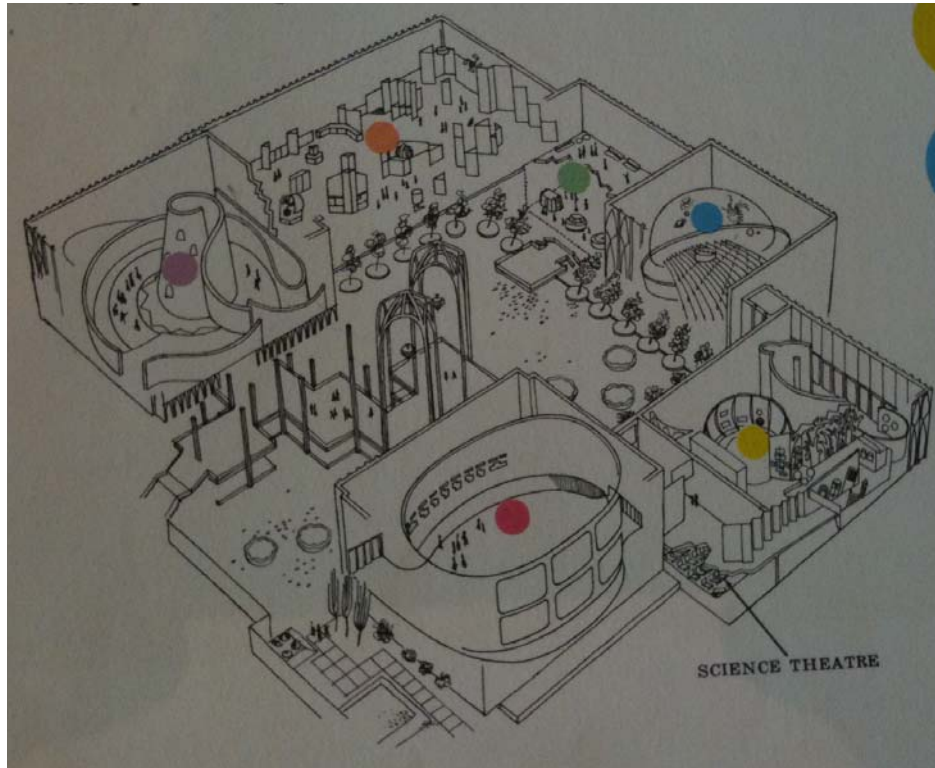

Figure 16 – 1962 Seattle World's Fair guidebook showing cut-away diagram of interior exhibits at the United States Science Pavilion



Figure 17 – 1969 exhibit at the Pacific Science Center (1986.5.50939, Seattle P-I Collection, MOHAI)



Figure 18 – Wayne State University McGregor Conference Center, Detroit, Michigan, by Minoru Yamasaki 1955-59



Figure 19 – Oberlin College Conservatory of Music buildings, Oberlin Ohio, 1963 by Minoru Yamasaki



Figure 20 – Reynolds Aluminum Building, Detroit, Michigan, by Minoru Yamasaki, 1959



Figure 21 – IBM Building, Seattle, 1964 (left) and Rainier Tower, Seattle, 1977 (right) both by Minoru Yamasaki



Figure 22 – Neighborhood context: view east from John Street



Figure 23 – Neighborhood context: view south from Seattle Center; 1982 Bay Vista Tower apartment building in background, Children's Theater on far right



Figure 24 – Neighborhood context: view west from John Street and 5th Avenue monorail tracks



Figure 25 – Neighborhood context: view west/northwest on 3rd Avenue from Belltown



Figure 26 – Neighborhood context: view along Broad Avenue of IMAX wing addition



Figure 27 – Neighborhood context: view of Pacific Science Center and Space Needle from upper main path at the Olympic Sculpture Garden on the Elliott Bay waterfront



Figure 28 – North entrance forecourt and entry towers, from northeast



Figure 29 – Entrance stairs and 1993 north entrance gate



Figure 30 – Building 5 (1962: Building 1) east elevation, and walkways



Figure 31 – Building 4 (1962: Building 2) east elevation, on left



Figure 32 – Laser Dome (1962: Building 3), north elevation



Figure 33 – Building 3 (1962: Building R), north elevation, on right; Building 2 (1964: Building 4) on left. 1962 viewing platform at center. Non-original features shown include 1993 pool pad and walk visible at right, tent, signage, glazed wall on Building 3, and all water features other than petalled fountain.



Figure 34 – Building 1 (1962: Building 5), center; Building 2 (1965: Building 4) on right



Figure 35 – Building 5 (1962: Building 1) first level conference room



Figure 36 – Building 5 (1962: Building 1) west elevation, and loading dock



Figure 37 – Southeast corner of site showing 1993 parking garage addition



Figure 38 – Pacific Science Center south perimeter elevation showing additions to Building 3 (1962: Bldg R) on right



Figure 39 – Pacific Science Center south perimeter elevation showing Building 2 (1962: Building 4) on left, and 1998 butterfly house and IMAX addition on right.



Figure 40 – Pacific Science Center, east perimeter elevation, showing 1998 butterfly house and IMAX addition behind trees; view from Seattle Center grounds



Figure 41 – Pacific Science Center, north elevation showing Building 1 (1962: Building 1) on right, and 1998 Boeing IMAX addition on left; view from Seattle Center grounds



Figure 42 – Building 1 (1962: Building 5) on right, 1998 Boeing IMAX addition on left; site of 1962 East Exhibit Garden



Figure 43 – Building 5 (1962: Building 1) on left, 1996 Discovery Labs addition on right (east elevation)



Figure 44 – Building 5 (1962: Building 1) on right, 1996 Discovery Labs addition on left (west elevation)



Figure 45 – Building 5 (1962: Building 1) first level corridor



Figure 46 – Building 5 (1962: Building 1) first level typical office; view through window of hallway of 1993 Discover Labs building addition



Figure 47 – View of Building 5 (1962: Building 1) first floor original exterior wall, from lobby and hallway of 1993 Discovery Labs addition. In 1962 these office windows overlooked the West Exhibit Garden.



Figure 48 – Building 5 (1962: Building 1) second level theater and structure behind curving wall



Figure 49 – Building 5 (1962: Building 1) second level theater



Figure 50 – Building 4 (1962:Building 2), interior, showing west ramp from mezzanine



Figure 51 – Building 4 (1962:Building 2), interior, showing exhibits and structure area



Figure 52 – Laser Dome (1962: Building 3) theater interior



Figure 53 – Laser Dome (1962: Building 3) theater; view of dome structure from interstitial space storage



Figure 54 – Building 3 (1962: Building R), interior, showing 1993 full height glazed wall



Figure 55 – Building 3 (1962: Building R), interior, showing Denny Way entrance below



Figure 56 – Building 2 (1962: Building 4), interior showing exhibits, and staff office area up stairs on left



Figure 57 – Building 2 (1962: Building 4), interior



Figure 58 – Building 1 (1962: Building 5), interior showing original mezzanine



Figure 59 – Typical basement view under original 1962 buildings



Figure 60 – 1998 Boeing IMAX Theater and Exhibit Wing addition; interior looking north; theater on right



Figure 61 – 1998 Boeing IMAX Theater and Exhibit Wing addition; interior looking southeast to Seattle Center grounds through windows on left



Figure 62 – 1993 north entry ticket kiosks



Figure 63 – 1993 north entry ticket kiosks



Figure 64 – 1962 entry towers, pools, fountains

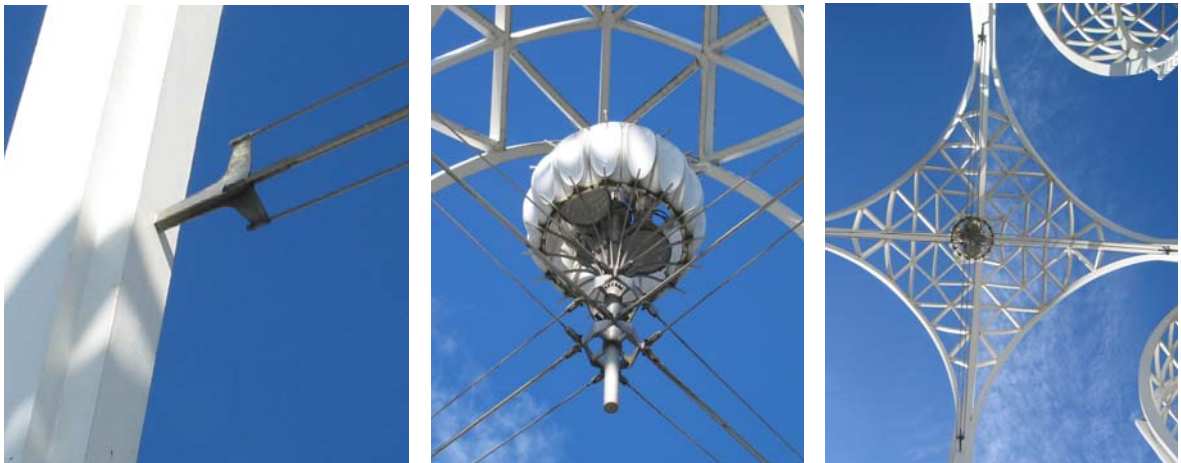

Figure 65 – 1962 entry towers, custom pendant light, custom hardware



Figure 66 – 1962 custom petalled fountain

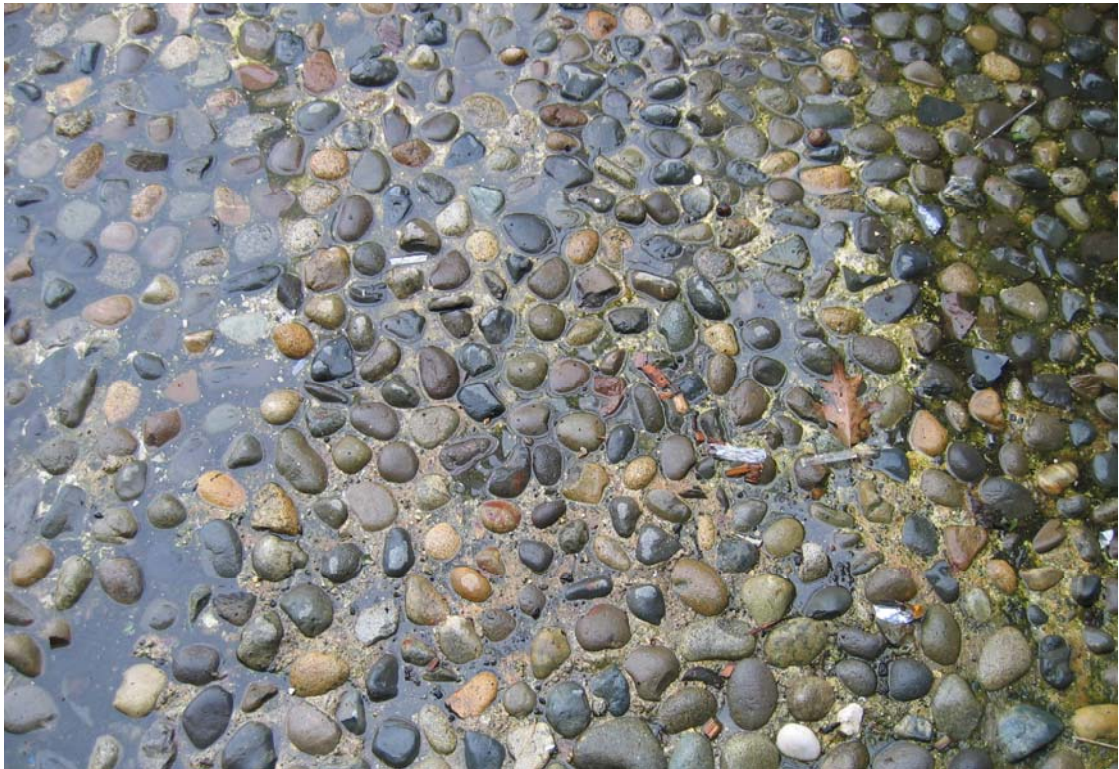

Figure 67 – 1962 pebble aggregate at pool bottom

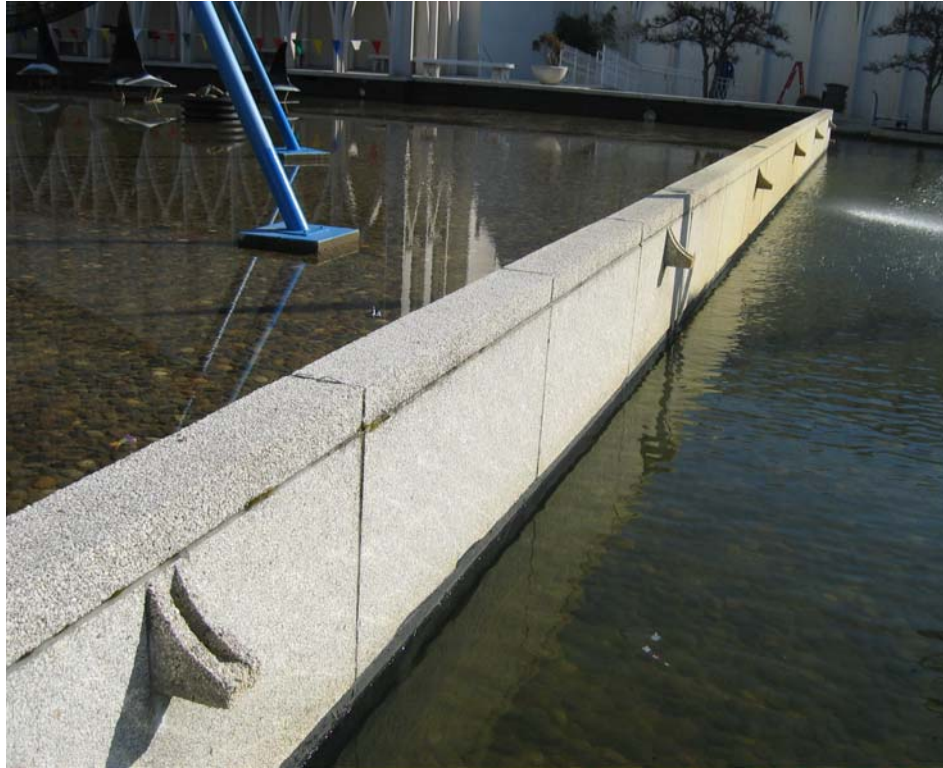

Figure 68 – 1962 wall separating pools



Figure 69 – 1962 planters – tree rings



Figure 70 – 1962 custom planters



Figure 71 – 1962 custom benches



Figure 72 – 1962 custom paving pattern (1 of 3)



Figure 73 – 1962 recessed light fixtures in walks



Figure 74 – 1962 walkways and railings



Figure 75 – 1962 underside of tower platform



Figure 76 – 1962 stairs and railings

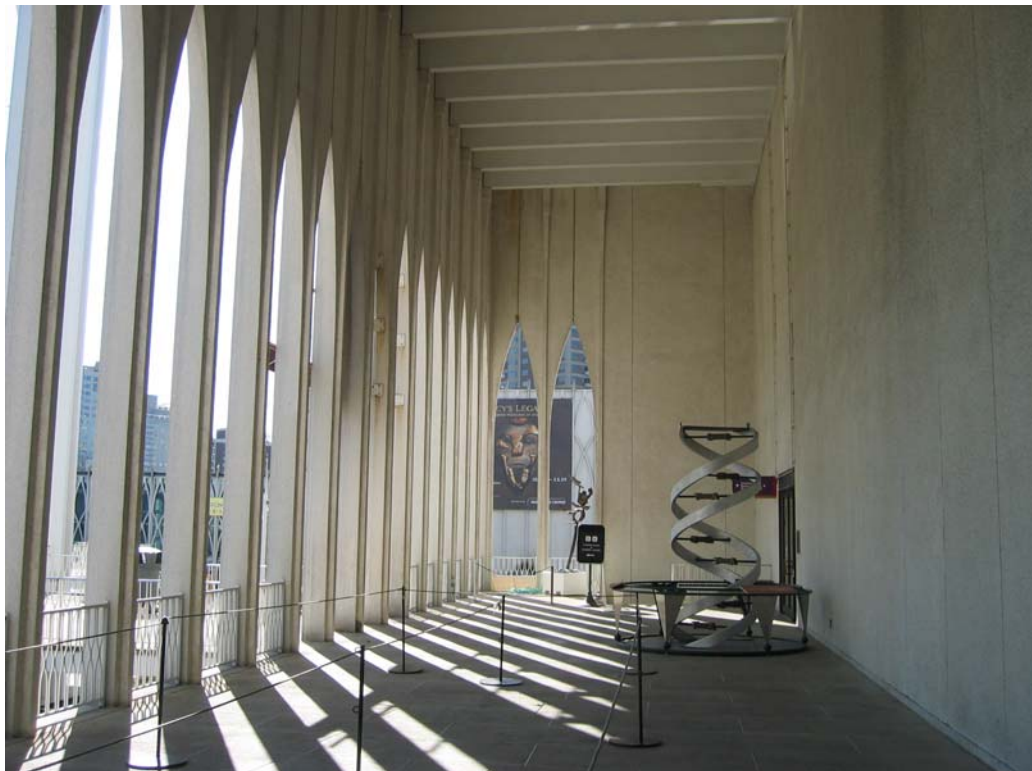

Figure 77 – 1962 porch at Building 5 (1962: Bldg 1)



Figure 78 – Wall from 1962 West Exhibit Garden



Figure 79 – Wall from 1962 West Exhibit Garden



Figure 80 – 1962 West & East Exhibit Gardens

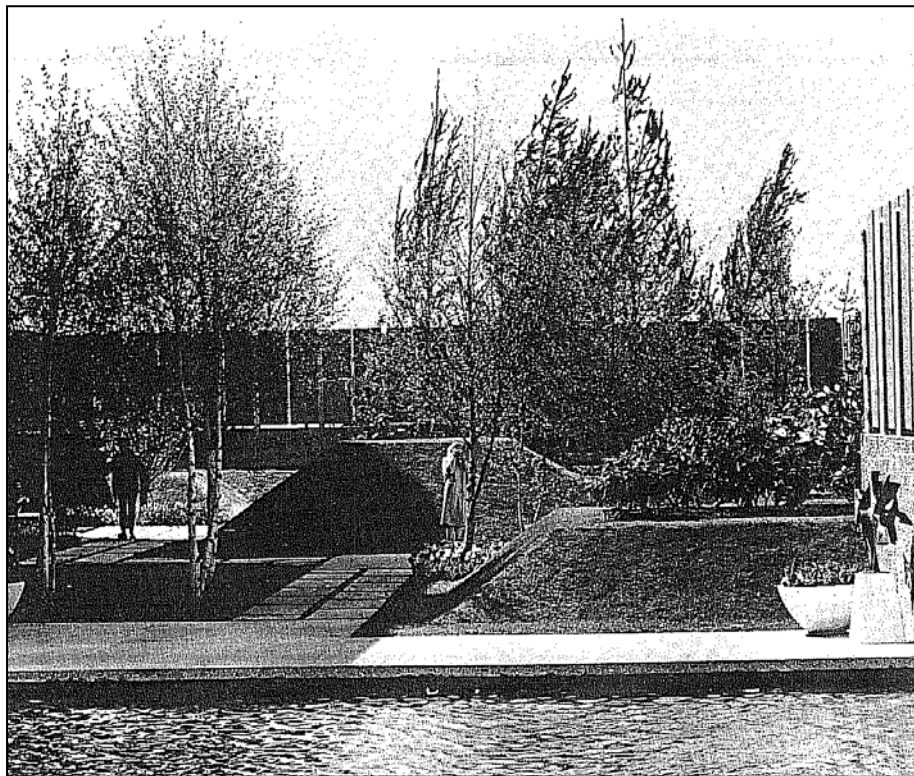

Figure 81 – 1962 West or East Exhibit Gardens, (from US Science Exhibit final report, p.52)



Figure 82 – West elevation, Building 4 (1962: Building 2), showing garage entry and drive aisle



Figure 83 – South elevation Building 4 (1962: Building 2) at left; west and south elevation Laser Dome (1962: Building 3) at middle and right; view from Pacific Science Center Parking Garage (not on site).



Figure 84 – Pacific Science Center Parking Garage (not on site; property line follows building face of original building), showing engagement with original retaining wall of Southwest Terrace. Western portion of south elevation of Laser Dome visible upper left.



Figure 85 – South elevation of Laser Dome (1962: Building 3) in background, with south retaining wall of Southwest Terrace in foreground. A temporary office trailer is visible under a wood canopy. The steel walkway canopy structure dates to 1992-93 renovations to create a south entry at Denny Way.



Figure 86 – Detail, south elevation Building 3 (1962: Building R). The steel walkway canopy structure dates to 1992-93 renovations to create a south entry at Denny Way.



Figure 87 – South elevation of Building 4, Laser Dome, and Building 3 (left to right). The steel walkway canopy structure and large glazed bay dates to 1992-93 renovations to Building 3 (1962: Building R) to create a south entry at Denny Way. Railing and balcony at middle of picture is original to 1962 building.



Figure 88 – South elevation of Building 3 (1962: Building R), east part. The steel walkway canopy structure and large glazed bay dates to 1992-93 renovations. Railing and balcony at middle of picture, as well as glazed openings at and between arches are original to 1962 building.



Figure 89 – South elevation of Building 3 (1962: Building R), central part. The steel walkway canopy structure and large glazed bay dates to 1992-93 renovations. Railing and balcony at middle of picture, as well as glazed openings at and between arches are original to 1962 building.



Figure 90 – South elevation of Building 3 (1962: Building R), at left, and south elevation of Building 2 (1962: Building 4) at right. The steel walkway canopy structure dates to 1992-93 renovations. Southeast Terrace retaining walls at lower right.



Figure 91 – Southeast Terrace pebbled retaining walls in foreground; south and east elevations of Building 3 (1962: Building R) at upper left; south elevation of Building 2 (1962: Building 4) at upper right.



Figure 92 – Detail, Raised viewing platform at south end of Central Courtyard. West and south elevation of Building 1 at upper left, and west elevation of Building 2 at upper right. Base of the Space Needle is visible in center distance.

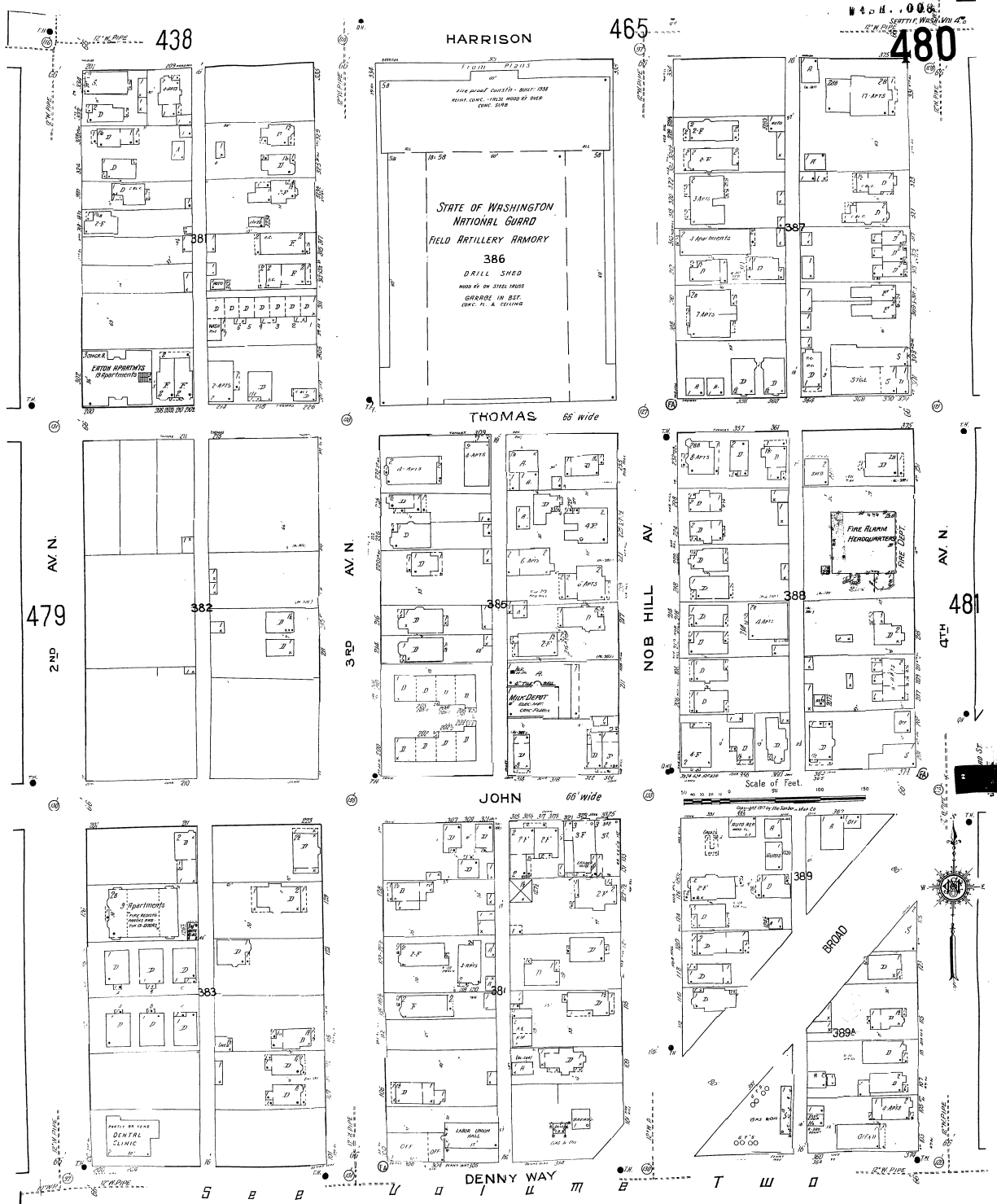
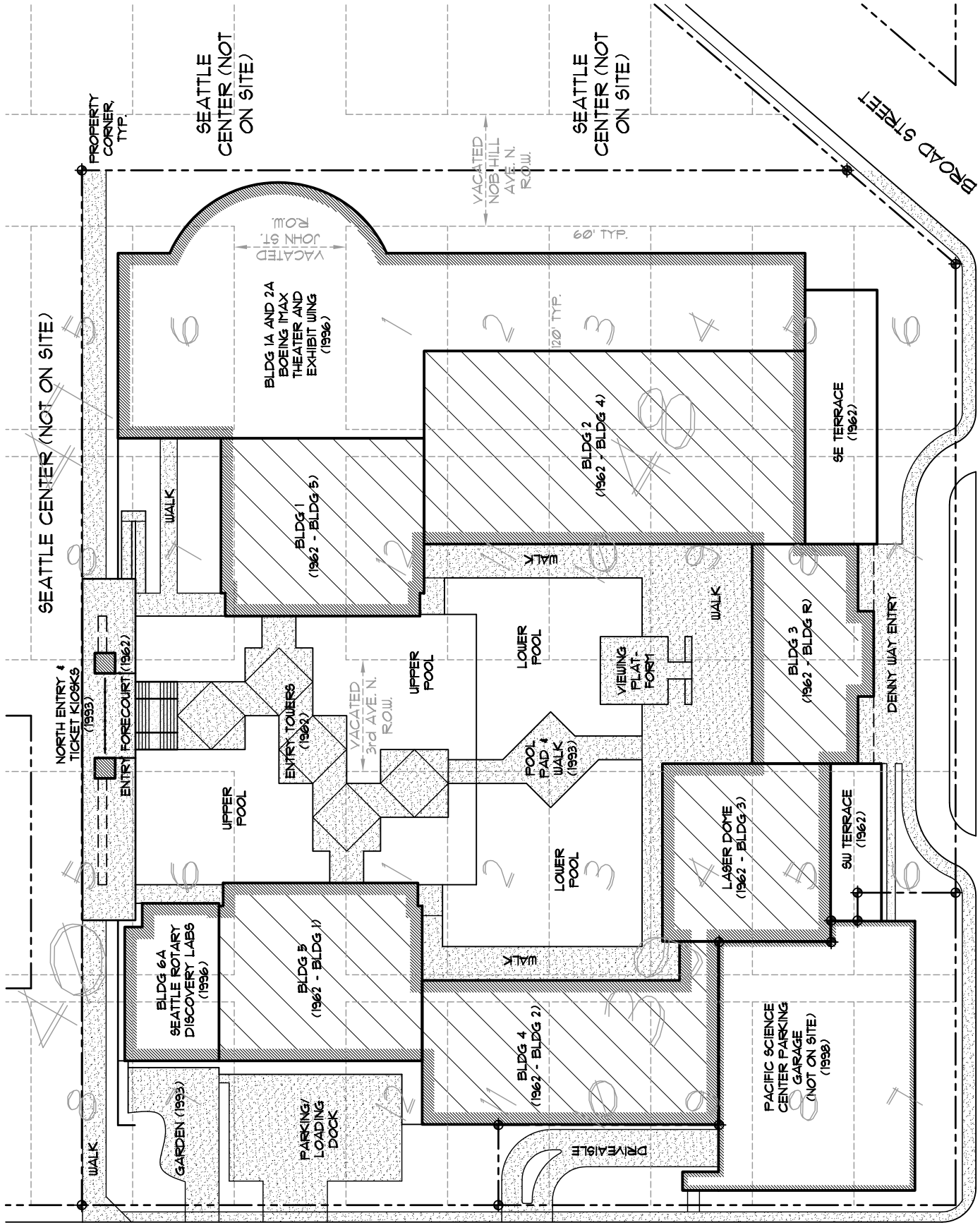

Figure 93 – Sanborn Fire Insurance map showing future United States Science Pavilion site, c. 1951 (at and south of intersection of John Street and 3rd Avenue N; compare to site plan)



2nd AVENUE N



SITE SKETCH FOR PACIFIC SCIENCE CENTER - SEATTLE HISTORIC LANDMARK NOMINATION

FEBRUARY 26, 2010

DENNY WAY

BROAD STREET

SEATTLE CENTER (NOT ON SITE)

SEATTLE CENTER (NOT ON SITE)

SEATTLE CENTER (NOT ON SITE)

PROPERTY CORNER TYP.

VACATED JOHN ST. ROWE

VACATED NOB HILL AVE N. ROW.

VACATED 3rd AVE N. ROW.

PACIFIC SCIENCE CENTER PARKING GARAGE (NOT ON SITE) (1998)

BLDG 6A SEATTLE ROTARY DISCOVERY LABS (1936)

BLDG 5 (1962 - BLDG 1)

BLDG 4 (1962 - BLDG 2)

LASER DOME (1962 - BLDG 3)

SW TERRACE (1962)

BLDG 3 (1962 - BLDG R)

BLDG 2 (1962 - BLDG 4)

BLDG 1 (1962 - BLDG 5)

BLDG 1A AND 2A BOEING MAX THEATER AND EXHIBIT WING (1956)

SE TERRACE (1962)

NORTH ENTRY & TICKET KIOSKS (1993)

ENTRY FORECOURT (1962)

ENTRY TOWERS (1962)

POOL PAD & WALK (1993)

VIEWING PLATFORM

DENNY WAY ENTRY

UPPER POOL

UPPER POOL

LOWER POOL

WALK

WALK

WALK

WALK

GARDEN (1993)

PARKING/LOADING DOCK

DRIVEABLE

60' TYP.

20' TYP.

FOLIO 1937

ADDITION DENNY'S DT 3RD TO N SEATTLE
SW 30 Twp 25 Range 4 Ewm. Block 3948 Lot or B. 39
Tract L. 1-6 49-12 20

PERMIT NO. 492782

DATE 11-19-61

Address 200 2ND AVE No. SEATTLE CENTER

For Owner U.S. GOVT

REAR #54 SCIENCE EXHIBIT BLDG

Condition of Exterior Interior Foundation Floor Plan: Good Accept: Good

USE EXHIBIT HALL
No. Stories
No. Stores
No. Rooms
Basement
No. Offices
No. Apartments
1 rm. 2 rm. 3 rm.
4 rm. 5 rm. 6 rm. Or

ROOF CONSTRUCTION
Frame Lam.
Mill Construction
Rein. Concrete PRECAST
No. Trusses
Wood INSUL
Steel
ROOFING MATERIAL
Tar and Gravel BU

FLOOR FINISHES
Fir Maple
Oak 2"x8" T&G
Lino. 2"x8" T&G
Cement
Terrazzo
Raccolith
Tile ASPH
Or CARPET

Tile Lino.
Baths Fl. Walls
Sq. Ft. Floors
Sq. Ft. Walls
Lin. Ft. Dr. Bds.
Sq. Ft. Floors
Sq. Ft. Walls
Lin. Ft. Dr. Bds.
Kit's Fl. Walls

PLUMBING
No. Fixtures
Toilets
Tub, Leg or Fem.
Basins, Ped.
Sinks
Urinals
Showers (Tub) (Stall)
Laundry Trays
H. W. Tank Fl. Drains
Sprink. Sys. No. Hds.

TYPE OF CONSTRUCTION
Frame
Single Double
Ordinary Masonry
Mill Construction
Class A Rein. Con.
Stru. Steel and Con.
Tile Brick
Con. Rein. Con.
Good Med. Cheap

Date Built 1962
Effective Age Years
Dep. for Cond. Dep. for Ob. Dep. for Ea. Total
Finished Unfinished Remodeled
Future Life Years

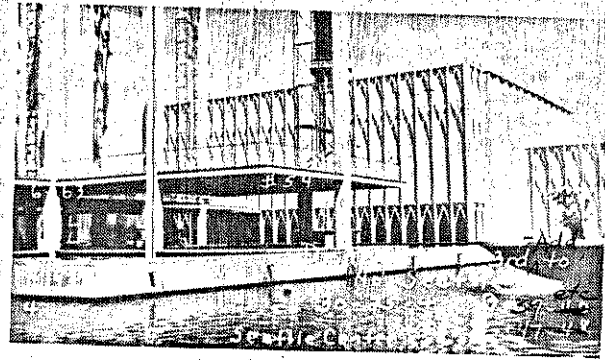
REPRODUCTION COST Factor Make-Up

Hoists: Elec. Hyd. Man. Average Length Paved Power Wiring Range Wiring No. Outlets

HEATING
Stove
Pipeless Furnace
Gravity H. A. HEAT PUMP
Air Cond., Fan
Suspended Gas, Hot Water
Steam Heat
Hot Water
Oil Burner

Year Assessed Value
1955 126,000 LL-63
71 252,000

FOUNDATION
Mud Sills
Post and Pier
Brick
Concrete
Pile

BASEMENT No
Full %
Sub-Basement
Size
Garage No. Cars
Floors
Plastered
Living Rooms
Service Rooms

EXTERIOR WALL CONST.
Single Double
2" x 4" Stud Walls
2" x 6" Stud Walls
Brick Walls
Brick with Pilasters
Concrete Walls
Con. with Pilasters
Tile Walls
Rein. Con. Skel.
Filler Walls
Laminated Walls

INTERIOR WALLS
Stud and Plaster
Lam. Plastered
Plywood
Celled
Plaster Board
Painted
Stain Varnish
Kalsomine
Whitewashed
Unfinished
CONC

C. H. GROUND FLOOR AREA 1260
TOTAL FLOOR AREA 1260
B 48'
SEE SUPPL SHEET

EXTERIOR FACING
Siding Shingles
Shakes Stucco
Brick Veneer
Stone Cast S.
Terra Cotta
Struc. Glass
Trim

INTERIOR TRIM
Fir
Mah. Oak
Metal
METAL Doors
NONE Windows
Stained
Varnished
Painted
Unfinished

FLOOR CONSTRUCTION
Joint Con. Size
O.C. In Bridg.
Mill Construction
Rein. Con.

Other Buildings	Construction	Floor	Roof	Stories	Dimensions	S. F. Area	Factor	Value	% Dep.	Deprec.	Net Value
Garage											

FOLIO 1937
 PERMIT NO. 492782
 DATE 11-9-61

ADDITION **Denny's Dr 3rd To N Seattle**
 Section **30** Twp **25** Range **4** Evm. Block **3148** Lot or **B. 39**
 Tract **L-1-6+9-12 etc -**
 Address **200 2ND AVE NO SEATTLE CENTER**
Blk # 53 SCIENCE EXHIBIT BLDG

Fee Owner **U.S. GOVT** Architect _____ Contractor _____
 Condition of Exterior **6** Interior **6** Foundation **6** Floor Plan: Good Accept. **6** Good

USE **EXHIBIT HALL**
 No. Stories **1**
 No. Stores
 No. Rooms
 Basement
 No. Offices
 No. Apartments
 1 rm. 2 rm. 3 rm.
 4 rm. 5 rm. 6 rm. Or

ROOF CONSTRUCTION
 Frame Lam.
 Mill Construction **PRECAST**
 Rein. Concrete
 No. Trusses
 Wood Steel
INSUL
 ROOFING MATERIAL
 Tar and Gravel **BU**

FLOOR FINISHES
 Fir Maple
 Oak 2"x6" T&G
 Lino. 3"x6" T&G
 Cement
 Terrazo
 Raecolith
 Tile **ASPH**

Tile Lino.
 Baths Fl. Walls
 Sq. Ft. Floors
 Sq. Ft. Walls
 Lin. Ft. Dr. Bds.
 Sq. Ft. Floors
 Sq. Ft. Walls
 Lin. Ft. Dr. Bds.
 Kit's Fl. Walls

PLUMBING
 A No. Fixtures
 D Toilets
 E Tub, Leg or Pom.
 S Basins, Fed.
 U Sinks
 A Urinals
 T Showers (Tub) (Stall)
 F Laundry Trays
 H. W. Tank Fl. Drain
 Sprink. Sys. No. Hds.

TYPE OF CONSTRUCTION
 Frame
 Single Double
 Ordinary Masonry
 Mill Construction
 Class A Rein. Con.
 Stru. Steel and Con.
 Tile Brick
 Con. Rein. Con.
 Good Med. Cheap

Date Built **1962** Finished Unfinished Remodeled
 Effective Age _____ Years Future Life _____ Years
 Dep. for Cond. _____ Dep. for Ob. _____ Dep. for Es. _____ Total _____

REPRODUCTION COST Factor Make-Up

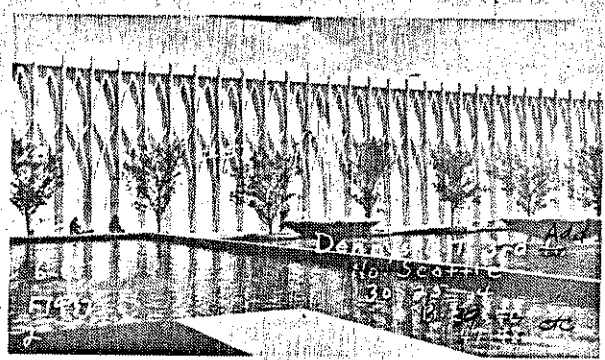

HEATING
 Stove
 Pipeless Furnace
 Gravity H. A.
 Air Cond., Fan **HEAT PUMP**
 Suspended Gas, Hot Water
 Steam Heat
 Hot Water
 Oil Burner

Year	Assessed Value
1964	245,800 LL-63
71	491,600

FOUNDATION
 Mud Sills
 Post and Pier
 Brick
 Concrete
 Pile

BASEMENT **NO**
 Full %
 Sub-Basement
 Size
 Garage No. Cars
 Floors
 Plastered
 Living Rooms
 Service Rooms

Map. Average Length _____ Paved _____
 Hoists: Elec. _____ Hyd. _____ Power Wiring _____ Range Wiring _____ No. Outlets _____

EXTERIOR WALL CONST.
 Single Double
 2" x 4" Stud Walls
 2" x 6" Stud Walls
 Brick Walls
 Brick with Pilasters
 Concrete Walls
 Con. with Pilasters
 Tile Walls
 Rein. Con. Skel.
 Filler Walls
 Laminated Walls

INTERIOR WALLS
 Stud and Plaster
 Lam. Plastered
 Plywood
 Ceiled
 Plaster Board
 Painted
 Stain Varnish
 Kaleomine
 Whitewashed
 Unfinished
 CONC

C. H.	1	2	3	4	5	6	7	8	9	10	11	12	13	14	15	16	17	18	19	20	21	22

GROUND FLOOR AREA **25875**
TOTAL FLOOR AREA 25875

SEE SUPPL SHEET

EXTERIOR FACING
 Siding Shingles
 Shakes Stucco
 Brick Veneer
 CONC Kind
 Stone Cast S.
 Terra Cotta
 Struc. Glass
 Trim

INTERIOR TRIM
 Fir
 Mah. Oak
 Metal
METAL Doors
NONE Windows
 Stained
 Varnished
 Painted
 Unfinished

FLOOR CONSTRUCTION
 Joint Con. Size _____
 O.C. In Bridg.
 Mill Construction
 Rein. Con.

Other Buildings	Construction	Floor	Roof	Stories	Dimensions	S. F. Area	Factor	Value	% Dep.	Deprec.	Net Value
Garage											

FOLIO 1937

ADDITION DENNY'S DT 3RD To N SEATTLE

PERMIT NO. 492782

Section 30 Twp 25 Range 4 Evm. Block 3948 Lot or Tract B. 39

DATE 11-19-61

Address 200 2ND AVE No SEATTLE CENTER

Blkg 52 A SCIENCE EXHIBIT BLDG

Fee Owner US GOV'T

Architect

Contractor

Condition of Exterior G Interior G Foundation G Floor Plan: Good Accept A Good

USE EXHIBIT HALL
No. Stories 4
No. Rooms
Basement
No. Offices
No. Apartments
1 rm. 2 rm. 3 rm.
4 rm. 5 rm. 6 rm.

ROOF CONSTRUCTION
Frame Lam.
Mill Construction
Rein. Concrete
No. Trusses
Wood Steel

FLOOR FINISHES
Fir Maple
Oak 2"x6" TAG
Lino. 3"x6" TAG
Concrete
Terrazo
Racolith
Tile

Tile Lino.
Baths Fl. Walls
Sq. Ft. Floors
Sq. Ft. Walls
Lln. Ft. Dr. Bds.
Sq. Ft. Floors
Sq. Ft. Walls
Lln. Ft. Dr. Bds.
Kit's Fl. Walls

PLUMBING
No. Fixtures
Toilets
Tub, Leg or Pan.
Basins, Ped.
Sinks
Urinals
Showers (Tub) (Stall)
Laundry Trays
H. W. Tank Fl. Drains
Sprink. Sys. No. Hds.

TYPE OF CONSTRUCTION
Frame
Single Double
Ordinary Masonry
Mill Construction
Class A Rein. Con.
Stru. Steel and Con.
Tile Brick
Con. Rein. Con.
Good Med. Cheap

Date Built 1962
Effective Age
Dep. for Cond. Dep. for Ob. Dep. for Ea. Total
Finished Unfinished Remodeled
Future Life Years

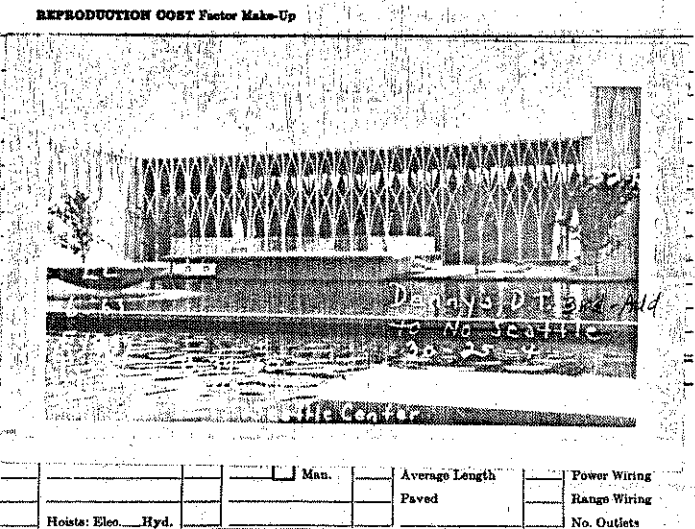

HEATING
Stove
Pipeless Furnace
Gravity H. A.
Air Cond. HEAT PUMP
Suspended Gas, Hot Water
Steam Heat
Hot Water
Oil Burner

Table with 2 columns: Year, Assessed Value. Row 1: 1965, 88,000 LL-63. Row 2: 71, 77,000.

FOUNDATION
Mud Sills
Post and Pier
Brick
Concrete
Pile

BASEMENT
Full %
Sub-Basement
Size
Garage No. Cars
Plastered
Living Rooms
Service Rooms

EXTERIOR WALL CONST.
Single Double
2" x 4" Stud Walls
2" x 6" Stud Walls
Brick Walls
Brick with Pilasters
Concrete Walls
Con. with Pilasters
Tile Walls
Rein. Con. Skel.
Laminated Walls

INTERIOR WALLS
Stud and Plaster
Lam. Plastered
Plywood
Coiled
Plaster Board
Painted
Stain Varnish
Kalsomine
Whitewashed
Unfinished
CONC

GROUND FLOOR AREA 7998

TOTAL FLOOR AREA 15996

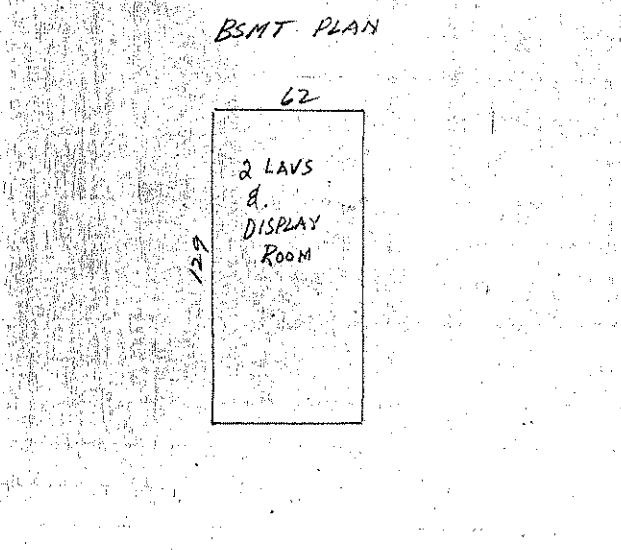

EXTERIOR FACING
Siding Shingles
Shakes Stucco
Brick Veneer
Stone Cast S.
Terra Cotta
Struc. Glass
Trim

INTERIOR TRIM
Fir
Mah. Oak
Metal
WOOD Doors
NONE Windows
Stained
Varnished
Painted
Unfinished

FLOOR CONSTRUCTION
Joint Con. Size
O.C. In Bridg.
Mill Construction
Rein. Con.

Table with 12 columns: Other Buildings, Construction, Floor, Roof, Stories, Dimensions, S.F. Area, Factor, Value, % Dep., Dprec., Net Value. Includes a row for 'Garage'.

FOLIO 1937

ADDITION DENNY'S DT 3RD TO N SEATTLE

0130

PERMIT NO. 492782

Section 30 Twp. 25 Range 4 Evm. Block 48148 Lot or Tract B. 39 L-1-6+9-12 etc

DATE 11-19-61

Address 200 2ND AVENUE SEATTLE CENTER

BLDG # 52 SCIENCE EXHIBIT BLDG

Fee Owner U.S. GOVT Condition of Exterior G Interior G Foundation G Floor Plan: Good Contractor Accept V Good

USE EXHIBIT HALL No. Stories No. Rooms Basement No. Offices No. Apartments 1 rm. 2 rm. 3 rm. 4 rm. 5 rm. 6 rm.

ROOF CONSTRUCTION Frame Lam. Mill Construction Reinf. Concrete No. Trusses Wood Steel ROOFING MATERIAL Tar and Gravel Or BU

FLOOR FINISHE Fir Maple Oak 2"x8" T&G Lino. 4"x8" T&G Cement Terrazo Baseolith Tile CARPET

Tile Lino. Baths Fl. Walls Sq. Ft. Floors Walls Lin. Ft. Dr. Bds. Sq. Ft. Floors Walls Sq. Ft. Walls Lin. Ft. Dr. Bds. Kit's Fl. Walls

PLUMBING No. Fixtures Toilets Tub, Leg or Pcm. Basins, Ped. Sinks Urinals Showers (Tub) (Stall) Laundry Trays H. W. Tank Fl. Drains Sprink. Sys. No. Hds.

TYPE OF CONSTRUCTION Frames Single Double Ordinary Masonry Mill Construction Class A Rein. Con. Stru. Steel and Con. Tile Brick Con. Rein. Con. Good Med. Cheap

Date Built 1962 Finished Unfinished Remodeled Effective Age Years Future Life Years Dep. for Cond. Dep. for Ob. Dep. for Ea. Total

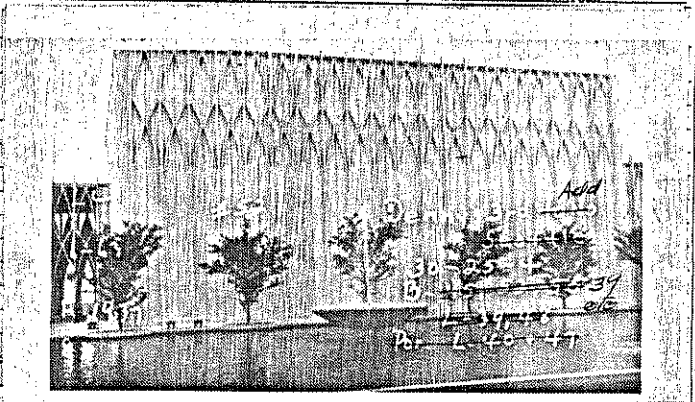

HEATING Stove Pipeless Furnace Gravity H. A. Air Cond., Fan Suspended Gas, Hot Water Steam Heat Hot Water Oil Burner

Table with columns: Year, Assessed Value. 1964 119,200 LL-63 71 220,400

FOUNDATION Mud Sills Post and Pier Brick Concrete File

BASEMENT Full % Sub-Basement Size Garage No. Cars Floors Plastered Living Rooms Service Rooms

Auto. Elec. Hyd. Man. Treated Piles, Timb. Untreated Treated Piles only Average Length Paved Hoists: Elec. Hyd.

Knob & Tube Floz. Cable Conduit Power Wiring Range Wiring No. Outlets

EXTERIOR WALL CONST. Single Double 2" x 4" Stud Walls 2" x 8" Stud Walls Brick Walls Brick with Pilasters Concrete Walls Con. with Pilasters Tile Walls Rein. Con. Skel. Filler Walls Laminated Walls

INTERIOR WALLS Stud and Plaster Lam. Plastered Plywood ALUM BOARD Ceiled PEGBOARD Plaster Board Painted Stain Varnish Kalsomine Whitewashed Unfinished

C. H. GROUND FLOOR AREA 10,500

INTERIOR TRIM Fir Mah. Oak Metal METAL Doors NONE Windows Stained Varnished Painted Unfinished

Table with columns: B, 1, 2, 3, 4, 5, 6, 7, 8, 9, 10, 11, 12, 13, 14, 15, 16, 17, 18, 19, 20, 21, 22. Includes handwritten note: SEE SUPPL SHEET

EXTERIOR FACING Siding Shingles Shakes Stucco Brick Veneer CONC Kind Stone Cast S. Terra Cotta Struc. Glass Trim

FLOOR CONSTRUCTION Joint Con. Size O.C. In Bridg. Mill Construction Rein. Con.

Table with columns: Other Buildings, Construction, Floor, Roof, Stories, Dimensions, S. F. Area, Factor, Value, % Dep., Deprec., Net Value

FOLIO 1937

ADDITION DENNY'S DT 3RD TO No. SEATTLE

Section SW 30 Twp. 25 Range 4 Ewm. Block 39, 48 Lot or Tract

PERMIT NO. 492782

DATE 11-19-61

Address 200 2ND AVE No. SEATTLE CENTER

Bldg # 51 SCIENCE EXHIBIT BLDG

For Owner G.S. GOVT

Condition of Exterior G Interior G Foundation G Floor Plan: Good Accept X Good

USE EXHIBIT HALL	ROOF CONSTRUCTION	FLOOR FINISHES	Tile	Plumbing
No. Stories	Frame Lam. <input type="checkbox"/>	Fir <input type="checkbox"/> Maple <input type="checkbox"/>	Baths <input type="checkbox"/> Fl. <input type="checkbox"/> Walls	No. Fixtures
No. Storos	Mill Construction	Oak <input type="checkbox"/> 2"x2" T&G	Sq. Ft. Floors	Toilets
No. Rooms	Rein. Concrete <input checked="" type="checkbox"/> <i>MSCL</i>	Lino. <input type="checkbox"/> 3"x3" T&G	Sq. Ft. Walls	Tub, Leg or Pom.
Basement	No. Trusses	Conent	Lin. Ft. Dr. Bds.	Basins, Ped.
No. Offices	Wood <input type="checkbox"/> Steel <input type="checkbox"/>	Terrazo	Sq. Ft. Floors	Sinks
No. Apartments	Roofing Material	Reoolith	Sq. Ft. Walls	Urinals
1 rm. <input type="checkbox"/> 2 rm. <input type="checkbox"/> 3 rm. <input type="checkbox"/>	Tar and Gravel <input checked="" type="checkbox"/> <i>BSPI</i>	Tile	Lin. Ft. Dr. Bds.	Showers (Tub) (Stall)
4 rm. <input type="checkbox"/> 5 rm. <input type="checkbox"/> 6 rm. <input type="checkbox"/>	Or. <input type="checkbox"/>	Or. <input type="checkbox"/>	Kit's <input type="checkbox"/> Fl. <input type="checkbox"/> Walls	Laundry Trays

TYPE OF CONSTRUCTION

Frame Double

Single Ordinary Masonry

Mill Construction Class A *UP* Rein. Con.

Stru. Steel and Con.

Tile Brick

Con. Rein. Con.

Good Med. Cheap

Date Built *1962* Finished Unfinished Remodeled

Effective Age _____ Years Future Life _____ Years

Dep. for Cond. _____ Dep. for Ob. _____ Dep. for Ex. _____ Total _____

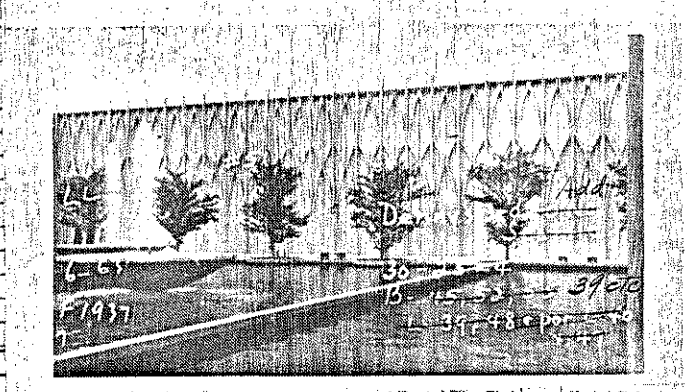

FOUNDATION

Mud Sills

Post and Pier

Brick

Concrete

Pile

BASEMENT *N/D*

Full %

Sub-Basement

Size _____

Garage No. Cars _____ Floors _____

Plastered

Living Rooms

Service Rooms

Auto. Elec. Treated Piles, Timb. Knob & Tube

Man. Hyd. Untreated Fix. Cable

Man. Average Length _____ Conduit _____

Hoists: Elec. Hyd. Paved _____ Power Wiring _____

Range Wiring _____ No. Outlets _____

EXTERIOR WALL CONST.

Single Double

2" x 4" Stud Walls

2" x 8" Stud Walls

Brick Walls

Brick with Pilasters

Concrete Walls

Con. with Pilasters

Tile Walls

Rein. Con. Skel.

Filler Walls

Laminated Walls

INTERIOR WALLS

Stud and Plaster

Lam. Plastered

Plywood

Celled

Plaster Board

Painted

Stain Varnish

Kahomine

Whitewashed

Unfinished *CONC*

G. H. GROUND FLOOR AREA 15450

TOTAL FLOOR AREA 15450

EXTERIOR FACING

Siding Shingles

Shakes Stucco

Brick Veneer *CONC*

Stone Cast S.

Terra Cotta

Struc. Glass

Trim

INTERIOR TRIM

Fir

Mah. Oak

Metal *METAL* *Deers*

NAME *Windows*

Stained

Varnished

Painted

Unfinished

FLOOR CONSTRUCTION

Joint Con. Size _____

O.C. In Bridg.

Mill Construction

Rein. Con.

32	SEE SUPPL SHEET
----	-----------------

Other Buildings	Construction	Floor	Roof	Stories	Dimensions	S. F. Area	Factor	Value	% Dep.	Dopro.	Net Value
Garage											

FOLIO 1937

ADDITION DENNIS ST 3RD TO N SEATTLE SW 30 Twp 25 Range 4 Ewn. Block 3945 Lot or #11 B. 39 see legal on back

PERMIT NO. 492782

Tax-Ext 48347 Tract 1-6-49-12 etc

DATE 11-19-61

Address 200 2ND AVE N SEATTLE CENTER

BLDG # 50 SCIENCE EXHIBIT BLDG

Fee Owner U.S. GOVT Architect Contractor Condition of Exterior G Interior G Foundation G Floor Plan: Good Accept X Good

USE EXHIBIT HALL ROOF CONSTRUCTION FLOOR FINISHES Title Lino PLUMBING

TYPE OF CONSTRUCTION Date Built 1962 Effective Age Years

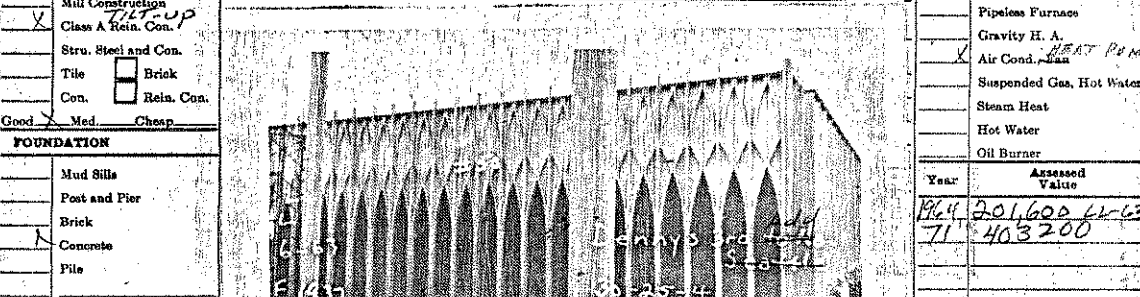

FOUNDATION BASEMENT No. of Cars EXTERIOR WALL CONSTR. INTERIOR WALLS

EXTERIOR FACING INTERIOR TRIM FLOOR CONSTRUCTION

Table with columns: Other Buildings, Construction, Floor, Roof, Stories, Dimensions, S. F. Area, Factor, Value, % Dep., Deprec., Net Value

2ND FLR PLAN (SEE SUPPL SHEET FOR 1ST FLR PLAN)

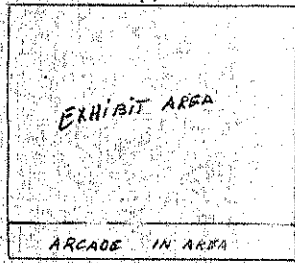

FOLIO 1937. ADDITION DENNY'S DT 3RD ^{ADD} 79 N. SEATTLE
 DATE Section 30 Twp. 25 Range 4 Evm. Block ~~8848~~ Lot or B. 39
 Tax Lot ~~48, 49~~ Tract 1-16 + 9-12 etc.
 ADDRESS 200 2ND AVE No. SEATTLE CENTER
 Fee Owner U.S. GOVT

PLOT PLAN & FIRST FLR PLAN
 SEE APPRAISAL SHEETS
 FOR 2ND FLR &
 BSMT PLANS

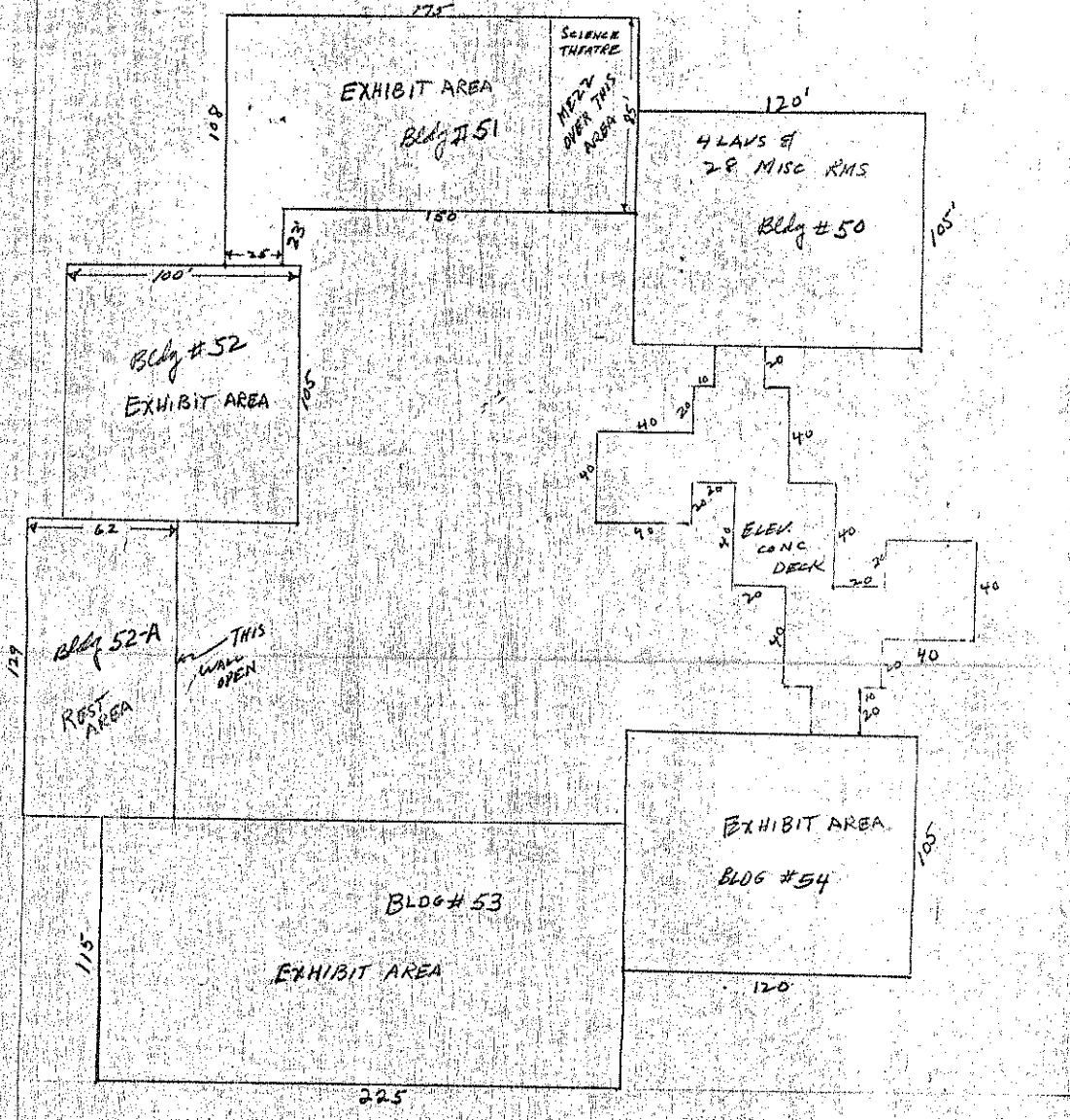

19852

Plot plan 0130

LIMITS	ROAD	SCHOOL	WATER	FIRE	SEWER	HOSPITAL	METRO	PK & REC
--------	------	--------	-------	------	-------	----------	-------	----------

198520-0130 X 779370 1100850 0010

Seattle-I							METRO	
-----------	--	--	--	--	--	--	-------	--

YR	AC	LAND	BLDGS	TOTAL	BY	DATE	REASON	CD	FEE OWNER	DATE	FILE #	PRICE
1964	84920	20200	105120	AL (in)	9/18/63	Merge (per Bldg Dept.)	1-4622					
'65	84920	1,099,850	1,184,770	7m	9/12/63	20200 Void - irrelevant New Imps. Seattle Center						
'65	84920	1,100,850	1,185,770	7m	9/13/63	Park Lot						
'65	779370	1,100,850	1,880,220	4m	3-9-64	RV						
71 XL1558740 B 2201700 T 3760440*198520-0130-0 8/9												

1972	1584230	2,489,230	4,073,960	PR	4-8-71	RD-D						
------	---------	-----------	-----------	----	--------	------	--	--	--	--	--	--