

Meadowbrook Swimming Pool



Dedicated
Tuesday, October 28, 1975



Your
Seattle
Parks and Recreation

Main Level Plan

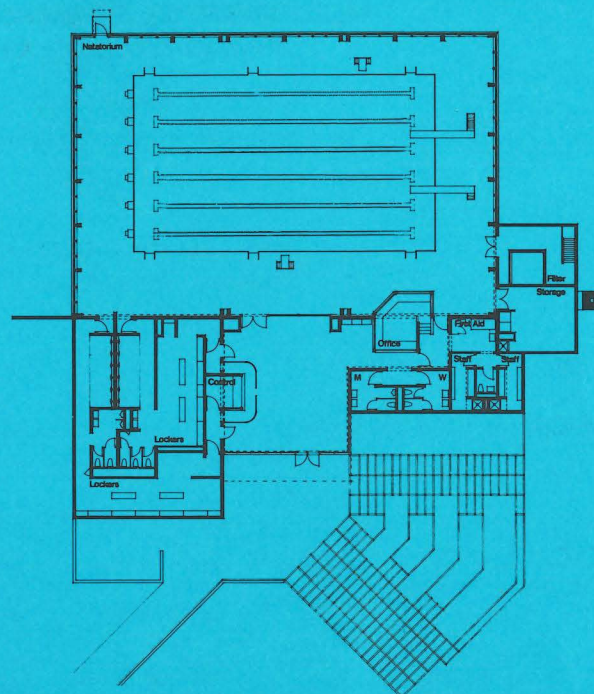

COST - \$825,000

BUILDING - 15,356 square feet

BUILDING MATERIALS - Glu-lam columns and beams with sawn timber purlins. Cement fiber decking, roof, and wall sheathing. Concrete masonry bearing walls. Wood shingle roofing and siding.

SKYLIGHTS - 2 clerestory windows with wire glass

CEILING HEIGHT - Varies, 38' in height

FLOOR - Broom finish concrete

GLAZING - Wire glass throughout

POOL SIZE - 44' x 75' 1"

POOL DEPTH - 3:0 x 12' 0"

GALLONS OF WATER - 200,000

WIDTH OF DECK - 15' N. & S. x 10' W. 16' 4" E.

POOL DECK DRAIN - Decko Drain, perforated stainless steel cover 3/4" wide, continuously around pool

POOL OVERFLOW SYSTEM - 12" wide, average 15" deep, serves as balancing deck

SIGHT AND BLIND LINE - Tapered hardboard railing on side of building, running the length of the pool to show exact depth of water.

FILTER - Swim Quip Mer-made - diatomaceous earth, five-hour turnover 420 square foot filter area, 30" x 36" rectangular filter elements

CHLORINATOR - 50 pound Fisher-Porter

LIGHTING - Underwater - 10 dry niche 500 watt lamps

Overhead - 4 tube fluorescent fixtures running continuously the length of pool providing indirect lighting

ELECTRICAL EQUIPMENT - Public address, record player, pool amplifier, intercom system, multiple portable system input jacks

COIN OPERATED LOCKERS - Stainless steel locker system, convertible from pay to free

DIVING STANDARDS - Cantilever, adjustable fulcrum, one 3-meter and one 1-meter - - specially designed safety hand rails

DIVING BOARDS - (2) Duraflex "maxiflex" 16' aluminum spring boards

COMPETITIVE LANES - (7) Kiefer-McNeil, non-turbulence racing lanes

LIFEGUARD TOWERS - Specially designed single pedestal - - two side ladders, equipped with p.a. and emergency buzzer

SAFETY LINE - (2) Kiefer-McNeil, with blue and white coilomatic floats

STARTING BLOCKS - Nor-Cal Champion take-off platforms

COMPETITIVE RACING CLOCKS - "Pace Clock" covered face, wall-mounted and portable

WATER POLO GOALS - Paragon designed to meet AAU standards

WATER SLIDE - Aquaslide deluxe line, queen size, left curve

SEATING - Portable bleachers

VENDING MACHINES - Space for four machines

WATER BASKETBALL GOALS

TRAINING LIFE JACKETS AND INNERTUBES - (12)

MEADOWBROOK SWIMMING POOL

A Forward Thrust Project

Northeast 105th Street
and 35th Avenue Northeast

DEDICATION PROGRAM

Tuesday, October 28, 1975

1:30 P.M.

MASTER OF CEREMONIES

Mrs. Harold Roe

I. MUSICAL INTRODUCTION

Nathan Hale Fife and Drum Corps

Weather permitting, Fife and Drum Corps will parade into building.

Pool Lobby

II. DEDICATION OF RAY LANDER MEMORIAL PLAQUE

Bud Olsen, Senior Recreation
Supervisor, Seattle Department of
Parks and Recreation

Pool Deck

III. NATIONAL ANTHEM PRESENTATION OF COLORS PLEDGE OF ALLEGIANCE

Nathan Hale Fife and Drum Corps

IV. INVOCATION

The Rev. Olin Nordsletten,
Pastor, Prince of Peace
Lutheran Church

V. WELCOME AND INTRODUCTIONS

David L. Towne, Superintendent
of Parks and Recreation

VI. DEDICATION OF POOL

The Honorable John Miller
Chairman, City Council Parks
and Public Grounds Committee

VII. ACCEPTANCE FOR COMMUNITY

William Walker, Chairman
Meadowbrook Advisory Council

VIII. ACCEPTANCE FOR YOUTH

James B. Notkin, President
Associated Students of Nathan Hale

IX. INVITATION TO COMMUNITY

Willis Ball, Recreation Manager
Northeast District, Seattle Department
of Parks and Recreation

POST-CEREMONY SWIMMING EXHIBITION

COMPETITIVE SWIM DEMONSTRATION
SYNCHRONIZED SWIM

Cascade Swim Club
Aqua Dive Synchronettes

WES UHLMAN, MAYOR

CITY COUNCIL MEMBERS

Sam Smith, President

George Benson

Tim Hill

Phyllis Lamphere

Paul Kraabel

Wayne D. Larkin

John R. Miller

Randy Revelle

Jeanette Williams

BOARD OF PARK COMMISSIONERS

Robert E. Kildall, Chairman

Herbert M. Tsuchiya, Vice-Chairman

Mrs. V. C. Van Ness

Thomas O. Wimmer

Calhoun Dickinson

Mrs. Bernice Moreland

Mrs. June A. Roats

SEATTLE DEPARTMENT OF PARKS AND RECREATION

David L. Towne, Superintendent

Robert Wilder, Deputy Superintendent for Management

C. M. Girtch, Deputy Superintendent for Operations

J. W. Tiemeyer, Director of Development

Virginia Swanson, Director of Community Recreation

MEADOWBROOK POOL STAFF

Greg Edwards, Pool Manager

Terrance Gertsch, Senior Guard

Vicki Anne Green, Cashier

Terry Welch, Pool Operator

ARCHITECT

Calvin/Gorasht, Architects

GENERAL CONTRACTOR

Elling Halvorson, Inc.

RAY LANDER MEMORIAL PLAQUE

*"Dedicated to the memory of Ray Lander, a friend
of the students of Nathan Hale High School and
Meadowbrook Recreation Center"*

Meadowbrook Community Center"

Plaque designed and cast by Harry March